

## JetString™ Sub

### Workstrings introduces a New Design Concept for Jet Subs

#### Purpose

- 2-in-1 tool to improve efficiency and flexibility of jetting/cleaning operations of BOP/Wellhead/Subsea Tree Profiles

#### Advantages

- Saves rig time with flexibility of tool
- Enhanced assembly for directional jetting
- Improves downhole equipment cleaning
- Reduces BOP surface maintenance times

#### New Design Concept Benefits

- JetString™ Sub can be run integral of the drill string for short trips
- Full JetString™ Sub with urethane Bull Nose can be a dedicated run with adjustable nose port
- Adjustable nozzle ports dressed open or closed to direct the desired flow and TFA
- Variety of nozzle standard sizes available
- Designed and verified with FEA
- XT57 and 6 5/8" FH designs available, with others pending

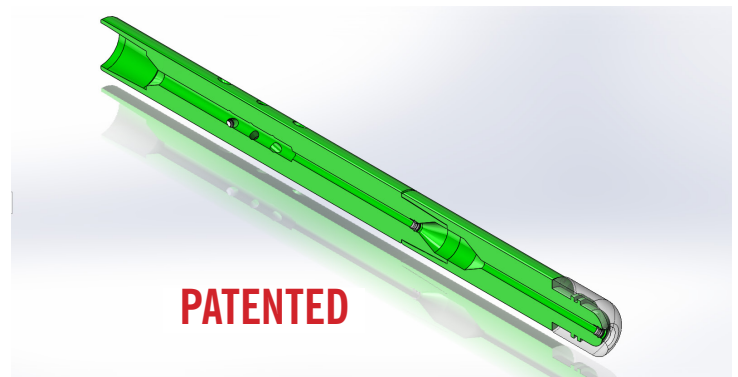
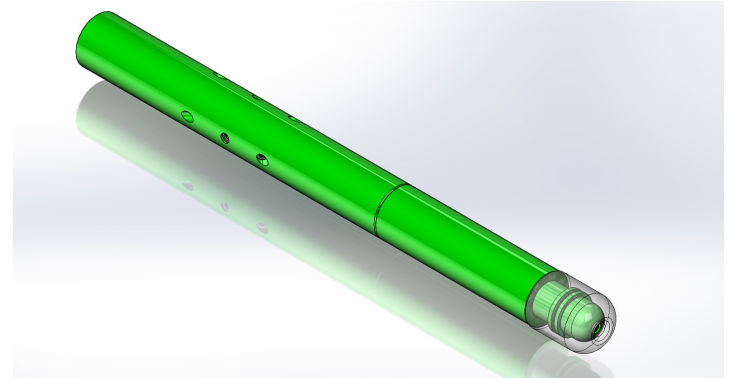

Please contact our Engineering Team for more information -

[engineering@workstrings.com](mailto:engineering@workstrings.com)

# Deep Inventory. Even Deeper Expertise.



Scan Code for all of our  
current specification sheets

**Global Headquarters**

1150 Smede Hwy  
Broussard, LA 70518 - USA  
Phone: +1 337.989.9675  
Email: [info@workstrings.com](mailto:info@workstrings.com)

**Engineering & Marketing**

1001 Louisiana St., Suite 2900  
Houston, TX 77002 - USA  
Phone: +1 281.999.0047  
Email: [marketing@workstrings.com](mailto:marketing@workstrings.com)

**EMEA Corporate**

Kirkton Avenue, Dyce  
Aberdeen, AB21 0BF - UK  
Phone: +44 1224.724900  
Email: [sales.uk@workstrings.com](mailto:sales.uk@workstrings.com)